

FORM NO. 1.

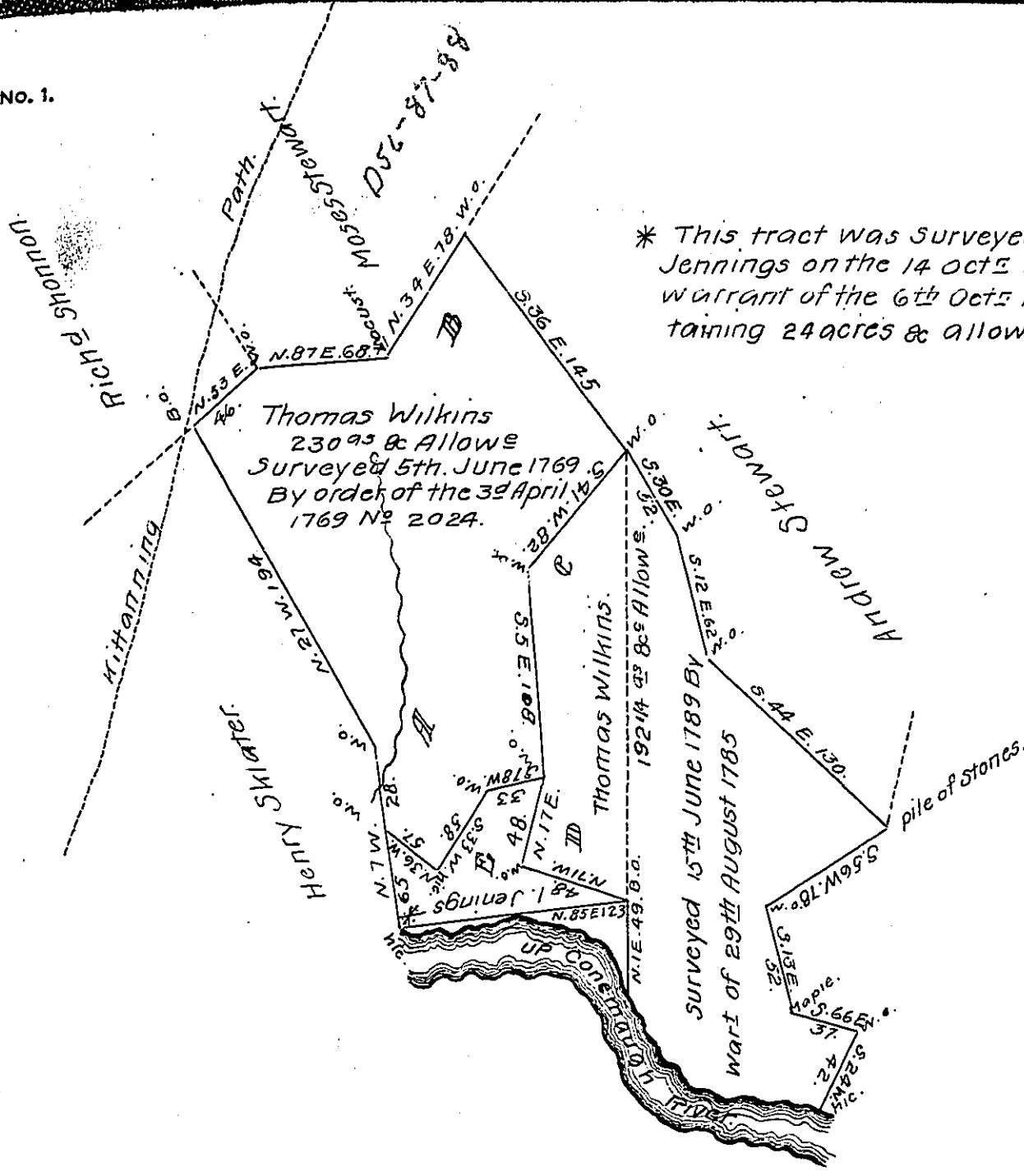

\* This tract was surveyed to Isaac Jennings on the 14 Oct<sup>r</sup> 1813 By warrant of the 6<sup>th</sup> Oct<sup>r</sup> 1813 containing 24 acres & allow<sup>s</sup>.

Thomas Wilkins  
230<sup>ac</sup> & Allow<sup>s</sup>  
Surveyed 5th June 1769  
By order of the 3<sup>d</sup> April 1769  
No 2024.

Surveyed 15<sup>th</sup> June 1789 By  
warrant of 29<sup>th</sup> August 1785

The dotted line and the letters A B C D & E on the above diagram represent a survey made to <sup>Samuel</sup> ~~Isaac~~ Culbertson on the 20<sup>th</sup> of February 1828 in pursuance of a Location granted to him the 3<sup>d</sup> April 1769 No 1873 It will be seen by the dates entered in the above drafts that the land called for by <sup>Samuel</sup> ~~Isaac~~ Culbertson's Location and upon which it has been Paid has been previously <sup>Samuel</sup> ~~Isaac~~ appropriated. David Lintner and Abner Wittels reside upon this tract and claim under the title to Thomas Wilkins - Isaac Thomas is the owner of the tract Surveyed to Isaac Jennings.

To Gabriel Heister Esquire.  
Surveyor Gen<sup>l</sup>.

John Taylor, D.S.

IN TESTIMONY that the above is a copy of the original remaining on file in the Department of Internal Affairs of Pennsylvania, made conformably to an Act of Assembly, approved the 16<sup>th</sup> day of February, 1833, I have hereunto set my Hand and caused the Seal of said Department to be affixed at Harrisburg, this ninth day of December, 1909.

*Henry Houck*  
Secretary of Internal Affairs.